

### Change of Crimp Terminals for the FR-BFP2 Inverter Option

Thank you for your continued patronage of Mitsubishi Electric drive control products.  
The crimp terminals for the FR-BFP2 inverter option will be changed.

#### 1. Products Affected

FR-BFP2-0.4K to 15K, FR-BFP2-H0.4K to H15K

#### 2. Details of the Change

The position of the labels on the power supply cable (black cable) and the earth (ground) cable (green and yellow striped cable) will be changed.

The change does not affect the quality, performance, or specifications of the products.

Example: R cable of the FR-BFP2-0.4K

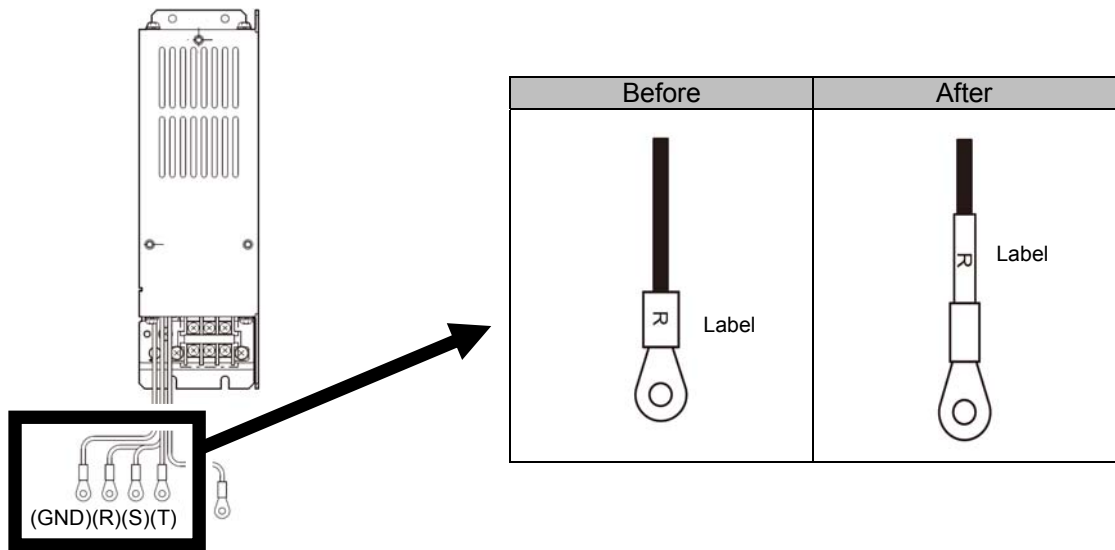

#### 3. Date of Change

The change will be sequentially applied to the products manufactured in July 2019 or later.

#### 4. Product Identification

The SERIAL (determined by date of production) can be checked on the product's rating plate.

□
9
7
○○○○○○  
Symbol Year Month Control number  
 SERIAL

The SERIAL consists of one symbol, two characters indicating the production year and month, and six characters indicating the control number.

The last digit of the production year is indicated as the Year, and the Month is indicated by 1 to 9, X (October), Y (November), or Z (December).

<b>Date of issue</b>	June 2019	<b>Title</b>	Change of Crimp Terminals for the FR-BFP2 Inverter Option	Mitsubishi Electric Corp., Nagoya Works 5-1-14 Yada-minami, Higashi-ku, Nagoya 461-8670 Tel.: +81 (52) 721-2111 Main line
----------------------	-----------	--------------	---	---