

KC/CE/EAC Marks Added to the General-Purpose Inverter Plug-in Option FR-LU08

Thank you for your continued patronage of Mitsubishi Electric drive control products.
 KC, CE, and EAC marks will be added to the general-purpose inverter plug-in option FR-LU08.

1. Products Affected

- FR-LU08
- FR-LU08-01 (IP55 compatible model)

2. Details of the Change

KC, CE, and EAC marks will be added to the label on the rear of the FR-LU08.
 The China RoHS mark on the FR-LU08 will be printed on the label.

(Example)

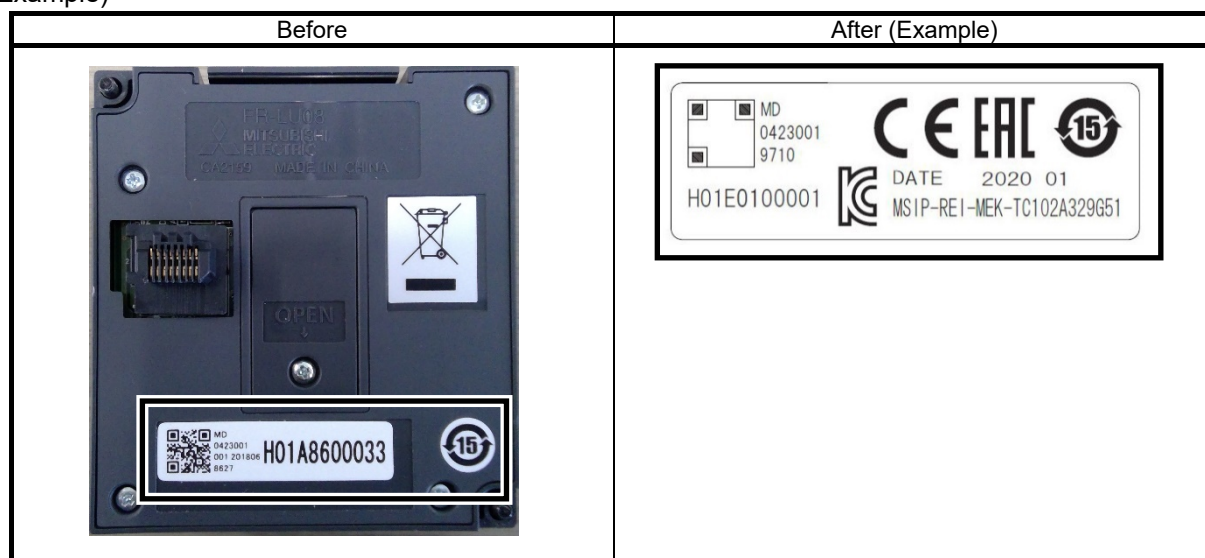

3. Date of Change

The change will be sequentially applied to the products manufactured in March 2020 or later.

4. Product Identification

The product can be identified by the presence/absence of the KC, CE, and EAC marks and the position of the China RoHS mark.

Date of issue	February 2020	Title	KC/CE/EAC Marks Added to the General-Purpose Inverter Plug-in Option FR-LU08	Mitsubishi Electric Corp., Nagoya Works 5-1-14 Yada-minami, Higashi-ku, Nagoya 461-8670 Tel.: +81 (52) 721-2111 Main line
----------------------	---------------	--------------	--	---