

### Appearance Change for Inverter Plug-in Option FR-A8NC (E kit)

Thank you for your continued patronage of Mitsubishi Electric drive control products.  
 The appearance of the FR-A8NC (E kit) plug-in option will be changed.

#### 1. Products Affected

- FR-A8NC (including coated models)
- FR-A8NC E kit (including coated models)

#### 2. Details of Change

The appearance of the product will be changed as shown in the following table due to addition of the 2D code (used for factory control).  
 The change does not affect the quality, performance, or specifications of the products.

(Example) FR-A8NC circuit board

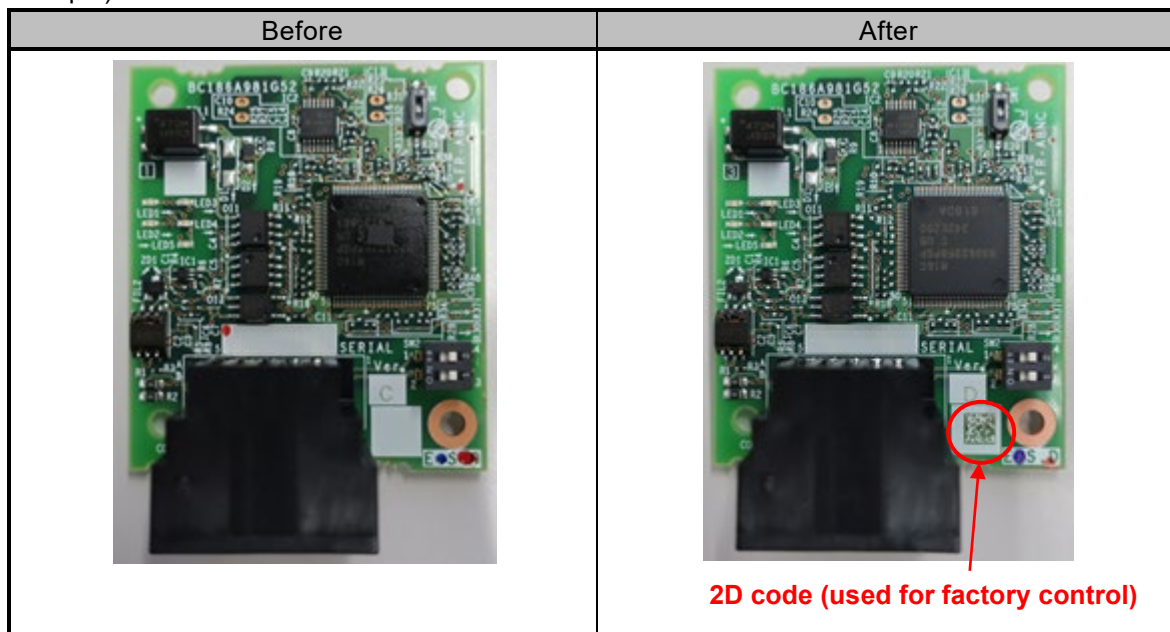

#### 3. Date of Change

The change will be applied to the products manufactured in April 2023 or later.

|                      |            |              |   |   |
|----------------------|------------|--------------|---|---|
| <b>Date of issue</b> | March 2023 | <b>Title</b> | Appearance Change for Inverter Plug-in Option FR-A8NC (E kit) | Mitsubishi Electric Corp., Nagoya Works<br>5-1-14 Yada-minami, Higashi-ku, Nagoya 461-8670<br>Tel.: +81 (52) 721-2111 Main line |
|----------------------|------------|--------------|---|---|

#### 4. Product Identification

The SERIAL (determined by date of production) can be checked on the circuit board or packaging plate of the plug-in option.

SERIAL example on rating plate  
□ 3 4 000  
Symbol Year Month Control number

SERIAL

SERIAL example on packaging plate  
□ 3 4 000  
Symbol Year Month Control number

SERIAL

The SERIAL consists of one symbol, two characters indicating the production year and month, and the control number (three characters).

The last digit of the production year is indicated as the Year, and the Month is indicated by 1 to 9, X (October), Y (November), or Z (December).