

# MITSUBISHI

Mitsubishi Electric Corporation **Industrial** Robot

## MELFA Technical News

BFP-A6079-0099E

September 2013

**Subject:** Report of MELFA-Works version 4.0/4.1 release

**Applicable to:** F series, S Q series, S D series, S series  
(CR750/CRnQ-700/CRnD-700/CRn-500 series robot controller)

Thank you for your continued support of Mitsubishi industrial robot "MELFA".

This Technical news describes the new version 4.0/4.1 of the MELFA-Works. (3F-21D-WINJ(E))

### 1. System requirements

- Corresponds to Windows7 (32bit/64bit).
- The storage medium was changed to DVD.
- The model number of MELFA-Works changed. 3D-21C-WINE→3F-21D-WINE

< attention >

The use environment in since MELFA-Works Ver. 4.0 is since SolidWorks2010.



## 2. Model addition

The following models were added.

**<RH-F Load maximum:3Kg>**

RH-3FH3515-D/Q RH-3FH4515-D/Q RH-3FH5515-D/Q

**<RH-F Load maximum:6Kg>**

RH-6FH3520-D/Q RH-6FH4520-D/Q RH-6FH5520-D/Q

RH-6FH3534-D/Q RH-6FH4534-D/Q RH-6FH5534-D/Q

**< RH-F Load maximum:6Kg / Clean specification>**

RH-6FH3520C-D/Q RH-6FH4520C-D/Q RH-6FH5520C-D/Q

RH-6FH3534C-D/Q RH-6FH4534C-D/Q RH-6FH5534C-D/Q

**< RH-F Load maximum:6Kg / Mist specification>**

RH-6FH3520M-D/Q RH-6FH4520M-D/Q RH-6FH5520M-D/Q

RH-6FH3534M-D/Q RH-6FH4534M-D/Q RH-6FH5534M-D/Q

**<RH-F Load maximum:12Kg>**

RH-12FH5535-D/Q RH-12FH5545-D/Q RH-12FH7035-D/Q RH-12FH7045-D/Q

RH-12FH8535-D/Q RH-12FH8545-D/Q

**<RH-F Load maximum:12Kg / Clean specification>**

RH-12FH5535C-D/Q RH-12FH5545C-D/Q RH-12FH7035C-D/Q RH-12FH7045C-D/Q

RH-12FH8535C-D/Q RH-12FH8545C-D/Q

**<RH-F Load maximum:12Kg / Mist specification>**

RH-12FH5535M-D/Q RH-12FH5545M-D/Q RH-12FH7035M-D/Q RH-12FH7045M-D/Q

RH-12FH8535M-D/Q RH-12FH8545M-D/Q

**< RH-F Load maximum:20Kg>**

RH-20FH8535-D/Q RH-20FH8545-D/Q RH-20FH10035-D/Q RH-20FH10045-D/Q

**< RH-F Load maximum:20Kg / Clean specification>**

RH-20FH8535C-D/Q RH-20FH8545C-D/Q RH-20FH10035C-D/Q RH-20FH10045C-D/Q

**< RH-F Load maximum:20Kg / Mist specification>**

RH-20FH8535M-D/Q RH-20FH8545M-D/Q RH-20FH10035M-D/Q RH-20FH10045M-D/Q

**<RV-F Load maximum:4Kg>**

RV-4F-D/Q RV-4F-SH-D/Q RV-4FL-D/Q RV-4FL-SH-D/Q

**<RV-F Load maximum:4Kg / Clean specification>**

RV-4FC-D/Q RV-4FLC-D/Q

**<RV-F Load maximum:4Kg / Mist specification>**

RV-4FM-D/Q RV-4FM-SM-D/Q RV-4FLM-D/Q RV-4FLM-SM-D/Q

**<RV-F Load maximum:7Kg>**

RV-7F-D/Q RV-7F-SH-D/Q RV-7FL-D/Q RV-7FL-SH-D/Q

**<RV-F Load maximum:7Kg / Clean specification>**

RV-7FC-D/Q RV-7FLC-D/Q

**<RV-F Load maximum:7Kg / Mist specification>**

RV-7FM-D/Q RV-7FM-SM-D/Q RV-7FLM-D/Q RV-7FLM-SM-D/Q

**<RV-F Load maximum:7Kg> (\*1)**

RV-7FLL-Q/D, RV-7FLL-Q/D-SH

**<RV-F Load maximum:13Kg>**

RV-13F-Q/D, RV-13F-Q/D-SH, RV-13FL-Q/D, RV-13FL-Q/D-SH

**<RV-F Load maximum:20Kg>**

RV-20F-Q/D, RV-20F-Q/D-SH

(\*1) super long arm

3. Corresponds to 8-Robot

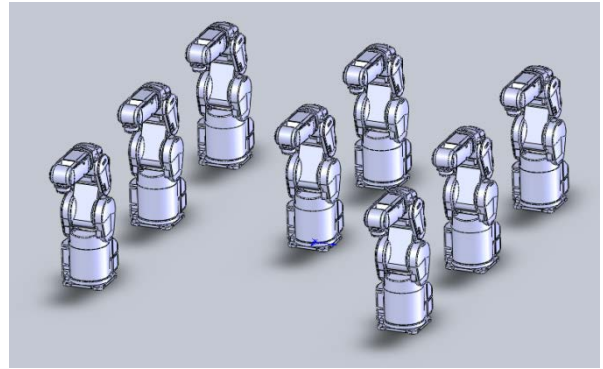

4. Add the function of the click position movement.

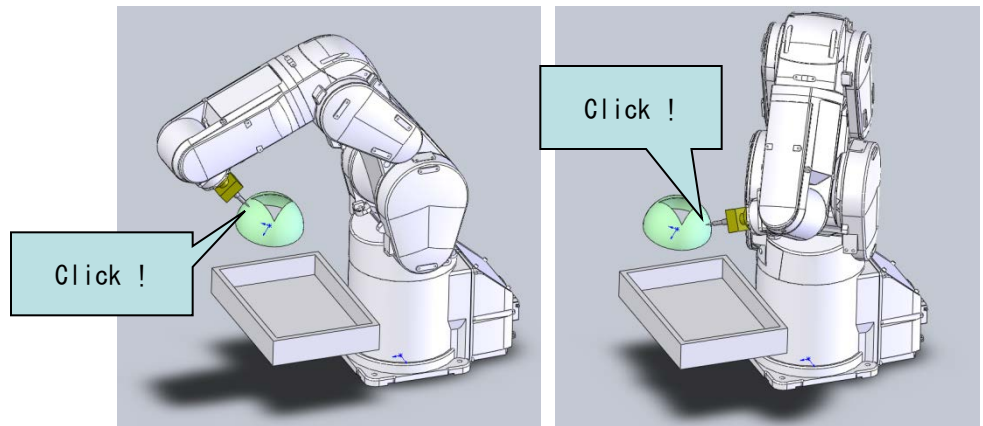

5. Add the output of a relative position function.

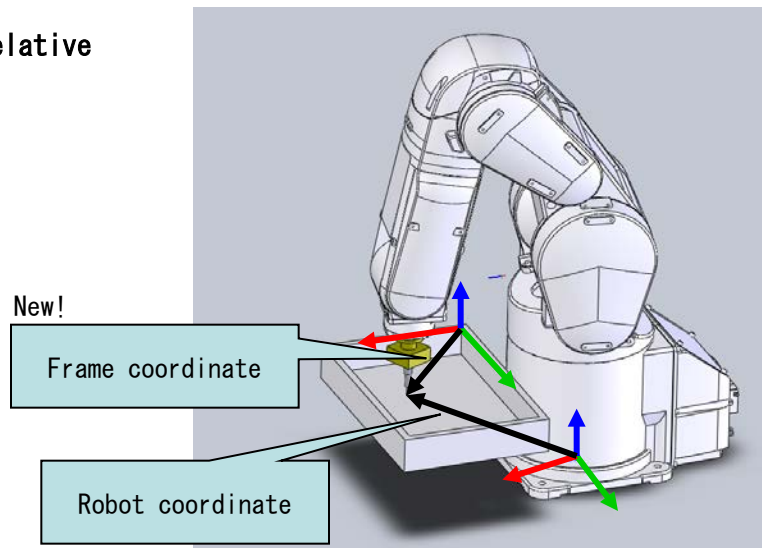

6. Bundled RT ToolBox2 (mini version) is changed to Ver. 2.50C.