

Change in Appearance of the LE-50PAU Power Amplifier

■Date of Issue

December 2022

■Relevant Models

Tension controllers

Thank you for your continued support of Mitsubishi Electric tension controllers.

We are informing you that the appearance of the LE-50PAU power amplifier will be changed.

Please note that there is no change in the general specifications, performance specifications, functions, and external dimensions of the products.

1 RELEVANT MODEL

Product	Model
A power amplifier for clutch	LE-50PAU

2 DETAILS ON THE CHANGE

The appearance of the connector that connects the LE-5AP/LE-5AP-E operator panel will be changed as follows.

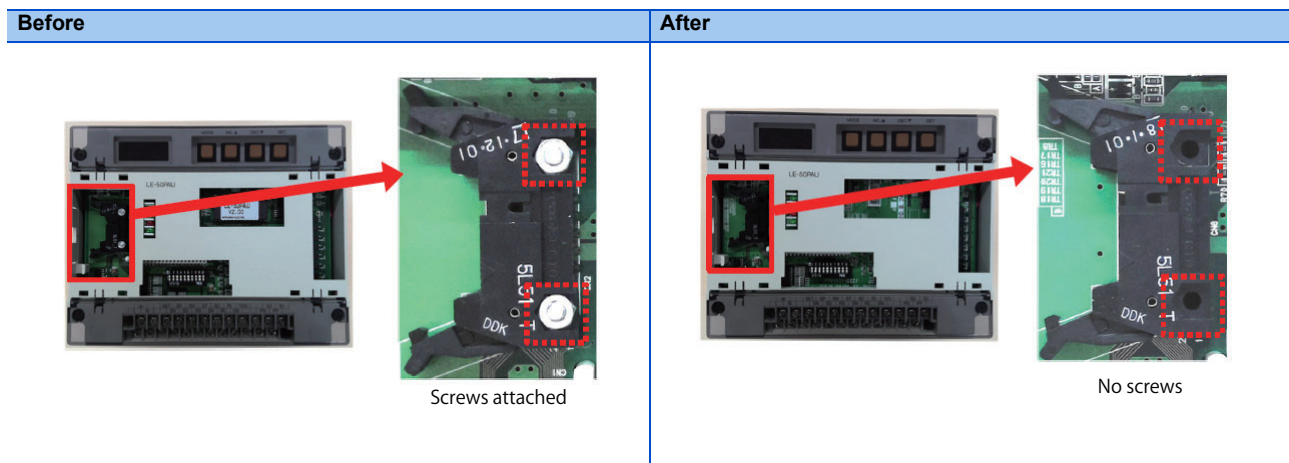

3 REASON FOR THE CHANGE

To improve the productivity

4 CHANGEOVER PERIOD

The change will apply to the products to be shipped in January 2023 and later.

There may be cases where products before the change and after the change exist in the distribution stage.

CT-A-0012-A

REVISIONS

Version	Date of Issue	Revision
A	December 2022	First edition

TRADEMARKS

The company names, system names and product names mentioned in this technical bulletin are either registered trademarks or trademarks of their respective companies.

In some cases, trademark symbols such as [™] or [®] are not specified in this technical bulletin.