

# MITSUBISHI ELECTRIC Inverter

## Sales and Service

No. 594E

### Change of Crimp Terminals for the FR-A800, FR-A800 Plus, FR-F800, FR-A701, FR-E700, FR-D700, and FR-F700PJ Inverters and the FR-XC, FR-HC2, FR-BU2, and FR-BFP2 Inverter Options

Thank you for your continued patronage of Mitsubishi Electric drive control products.

The crimp terminals for the FR-A800, FR-A800 Plus, FR-F800, FR-A701, FR-E700, FR-D700, and FR-F700PJ inverters and the FR-XC, FR-HC2, FR-BU2, and FR-BFP2 inverter options will be changed.

#### 1. Products Affected

FR-A820-1.5K to 3.7K(-GF/-CRN/-R2R), FR-A820-15K to 30K(-GF/-CRN/-R2R), FR-A820-55K to 90K(-GF/-CRN/-R2R),

FR-A840-0.4K to 15K(-GF/-CRN/-R2R), FR-A840-30K to 55K(-GF/-CRN/-R2R), FR-A842-315K to 500K(-GF/-CRN/-R2R),

FR-F820-2.2K to 3.7K, FR-F820-18.5K to 37K, FR-F820-75K to 110K, FR-F840-0.75K to 18.5K, FR-F840-37K to 75K, FR-F842-355K to 560K, FR-CC2-H315K to H560K, FR-D720-11K to 15K, FR-D740-11K to 15K, FR-E720-5.5K to 15K(-SC/-NC/-NF/-NE/-SC-TM), FR-E740-11K to 15K(-SC/-NC/-NF/-NE/-SC-TM),

FR-A721-5.5K to 55K, FR-A741-5.5K to 55K, FR-A8VPB-H,

FR-XC-37K to 55K(-PWM), FR-XC-H37K to H55K(-PWM), FR-XCB-18.5K and 22K, FR-XCB-H18.5K and H22K,

FR-HC2-7.5K to 90K, FR-HC2-H7.5K to H560K, FR-BU2-30K to 55K, FR-BU2-H30K to H75K, FR-A7PS,

FR-F720PJ-11K to 15K, FR-F740PJ-11K to 15K, FR-F720PJ-0.4KF to 15KF, FR-F740PJ-0.4KF to 15KF,

FR-BFP2-0.4K to 15K, FR-BFP2-H0.4K to H15K

<b>Date of issue</b>	March 2019	<b>Title</b>	Change of Crimp Terminals for the FR-A800, FR-A800 Plus, FR-F800, FR-A701, FR-E700, FR-D700, and FR-F700PJ Inverters and the FR-XC, FR-HC2, FR-BU2, and FR-BFP2 Inverter Options	Mitsubishi Electric Corp., Nagoya Works 5-1-14 Yada-minami, Higashi-ku, Nagoya 461-8670 Tel.: +81 (52) 721-2111 Main line
----------------------	------------	--------------	--	---

## 2. Details of the Change

Crimp terminals used in the affected products will be changed.

The change affects the appearance of the crimp terminals, but does not affect the quality, performance, or specifications of the products.

Example: FR-A820-5.5K

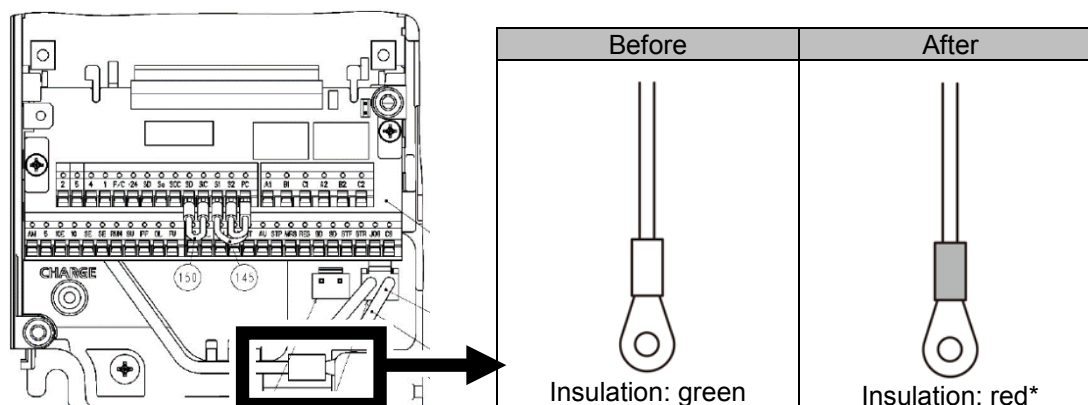

Note) Appearance of the product with the upper and lower front covers removed

\* The color of the insulation will differ depending on the wire gauge (red, blue, yellow, etc.)

Example: FR-E720-15K

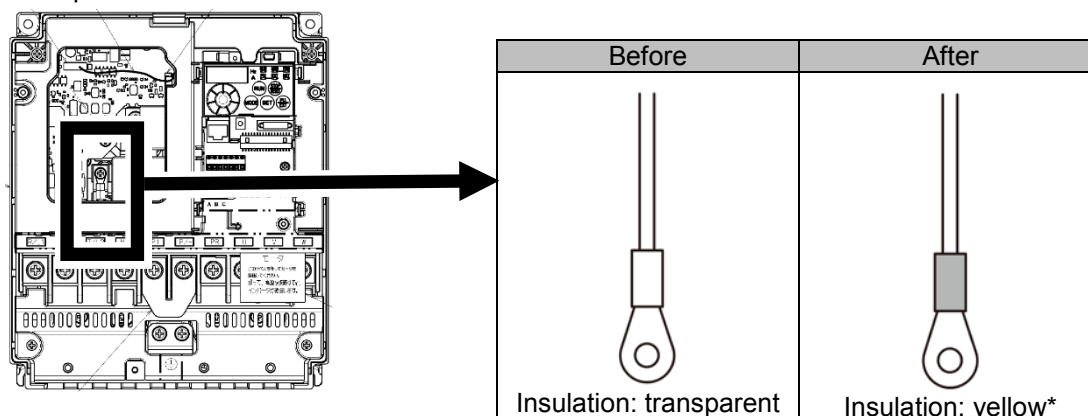

Note) Appearance of the product with the front cover removed

\* The color of the insulation will differ depending on the wire gauge (red, blue, yellow, etc.)

## 3. Date of Change

The change will be sequentially applied to the products manufactured in April 2019 or later.

## 4. Product Identification

The SERIAL (determined by date of production) can be checked on the product's rating plate.

□ 9 4 ○○○○○○  
Symbol Year Month Control number

SERIAL

The SERIAL consists of one symbol, two characters indicating the production year and month, and six characters indicating the control number.

The last digit of the production year is indicated as the Year, and the Month is indicated by 1 to 9, X (October), Y (November), or Z (December).