

MITSUBISHI ELECTRIC Inverter

Sales and Service

No. 811EC

Outer Appearance Change of the Harness for Connection between the Main Circuit Board and the Control Circuit Board for the FR-A800 Series Inverters, FR-F800 Series Inverters, FR-XC Series Multifunction Regeneration Converters, and FR-CC2 Series Converter Units

Thank you for your continued patronage of Mitsubishi Electric drive control products.
For the applicable models, the appearance of the harness for connection between the main circuit board and the control circuit board will be changed.

1. Products Affected

Series	Date of change	
	Sequentially applied to products from June 2025	To be sequentially applied to products from January 2026
FR-A800	FR-A820-00770(15K) to 01250(22K), FR-A840-00470(18.5K), FR-A840-00620(22K), FR-A860-00450, FR-A872-05690 to 07150	All models and all capacities except for those mentioned in the left column
FR-F800	FR-F820-00770(18.5K) to 01250(30K), FR-F840-00470(22K), FR-F840-00620(30K), FR-F860-00450	All models and all capacities except for those mentioned in the left column
FR-XC	All models and all capacities	
FR-CC2	FR-CC2-N450K to N630K	All models and all capacities except for those mentioned in the left column

2. Details of the Change

For the applicable models, the harness connector has been or will be changed from an eject type to a lock type for connection between the main circuit board and the control circuit board. The new connector is designed to resist coming off in the event of unexpected contact. The color of the cable has been or will be changed from black to white.

The connector on the control circuit board can be checked by removing the front cover.

For details, refer to the Instruction Manual of the applicable product.

Date of issue	Published in February 2025 Revised in December 2025	Title	Outer Appearance Change of the Harness for Connection between the Main Circuit Board and the Control Circuit Board for the FR-A800 Series Inverters, FR-F800 Series Inverters, FR-XC Series Multifunction Regeneration Converters, and FR-CC2 Series Converter Units	Mitsubishi Electric Corp., Nagoya Works 5-1-14 Yada-minami, Higashi-ku, Nagoya 461-8670 Tel.: +81 (52) 721-2111 Main line
----------------------	--	--------------	--	---

FR-A800 series, FR-F800 series, and FR-CC2 series: Connector position on the control circuit board
(Example: FR-A820-00770(15K))

Product view with the front cover removed



Connector on the control circuit board

* The shape of the product and the mounting position of the control circuit board differ depending on the model.

FR-XC series: Connector position on the control circuit board (Example: FR-XC-15K)

Product view with the front cover removed



Connector on the control circuit board

(Example) FR-A820-00770(15K)

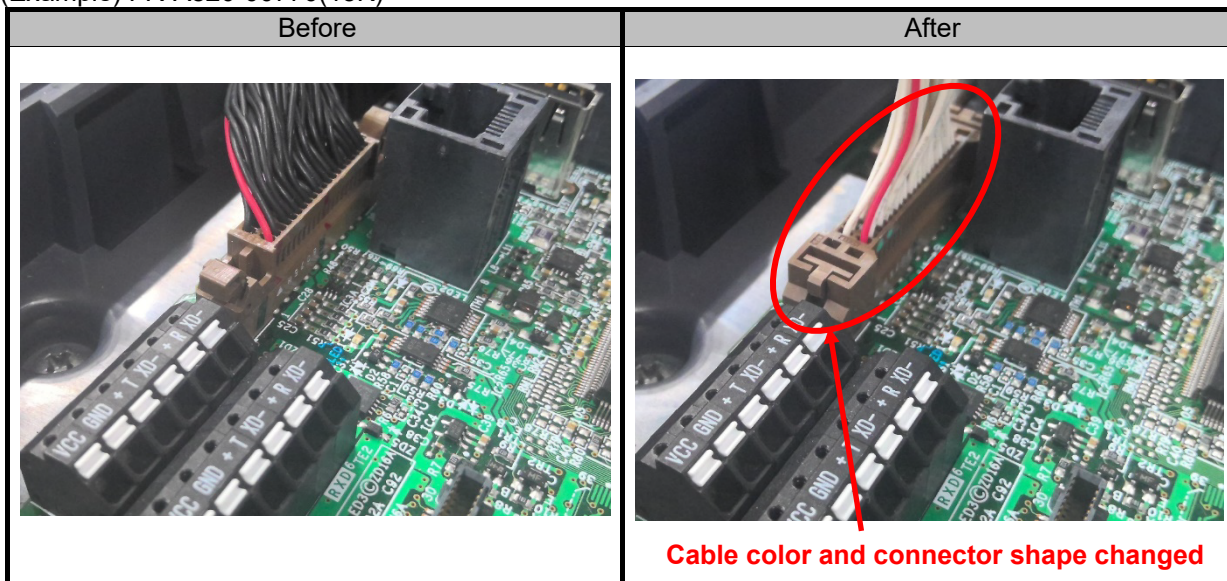

(Example) FR-XC-15K

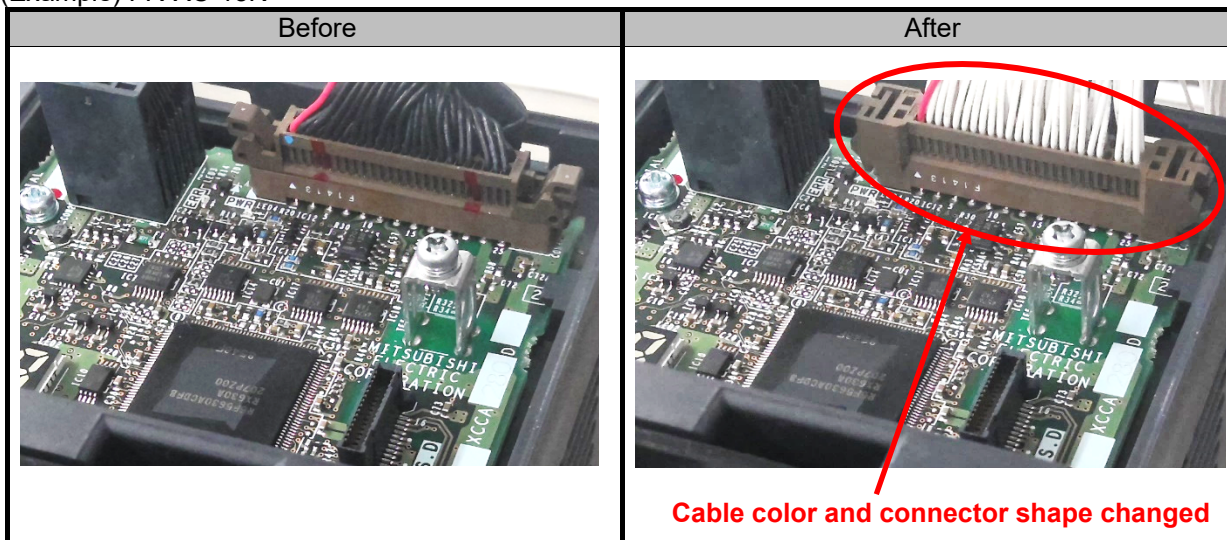

(Example) Enlarged view of the connector

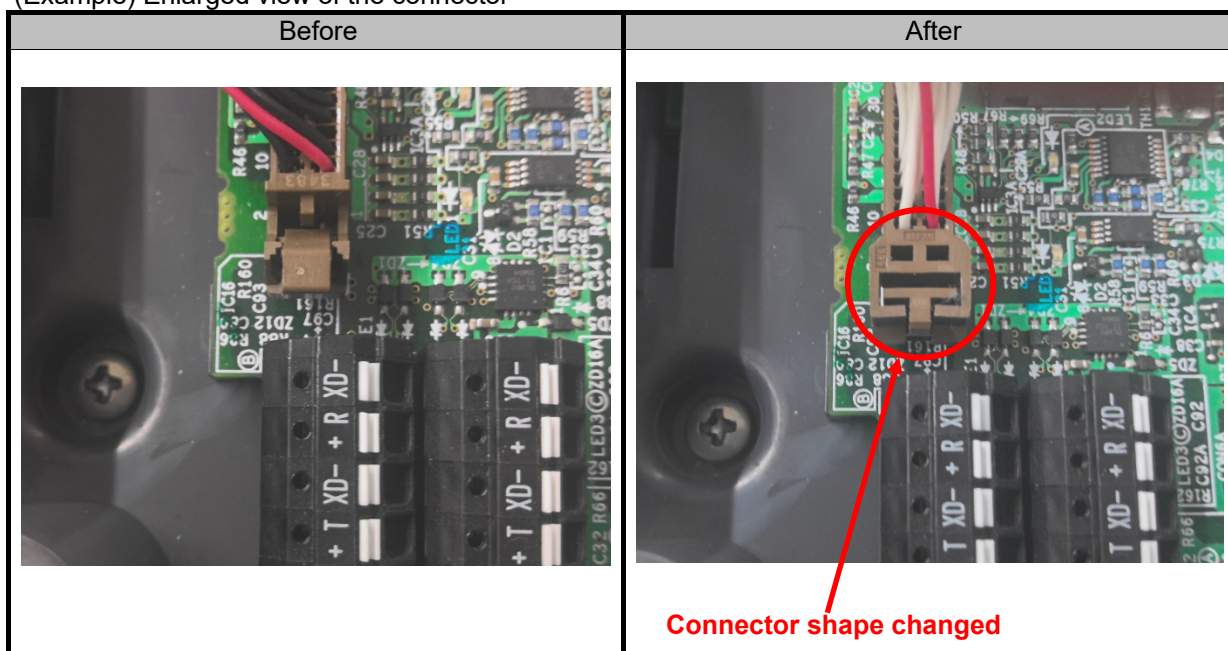

* The example shows the FR-A800 series connector shape, which is also common to the FR-F800 series, FR-CC2 series, and FR-XC series.

3. Date of Change

The change will be sequentially applied to all models and capacities manufactured in January 2026 or later.

For some capacities, changes have already been implemented since June 2025.

Refer to "1. Products Affected".

4. Product Identification

The products can be identified visually.